

KONICA MINOLTA



Product Showcase

bizhub C3110



- Mono/Colour
- 31ppm A4

Delivers high quality and yet
reduces print spend

TECHNICAL SPECIFICATIONS

SYSTEM SPECIFICATIONS

System memory	1 GB (standard) 2 GB (optional)
System hard disk	320 GB (optional)
Interface	10-Base-T/100-Base-TX/1,000-Base-T Ethernet; USB 2.0
Network protocols	TCP/IP (IPv4 / IPv6); SMB; LPD; IPP; SNMP; HTTP; HTTPS
Frame types	Ethernet 802.2; Ethernet 802.3; Ethernet II; Ethernet SNAP
Automatic document feeder	Up to 50 originals; A6–A4; 50–110 gsm RADF
Printable paper size	A6–A4; customised paper sizes
Printable paper weight	60–210 gsm
Paper input capacity	Standard: 350 sheets Max.: 850 sheets
Tray 1	250 sheets; A6–A4; 60–210 gsm
Tray 2 (optional)	500 sheets; A4; 60–90 gsm
Manual bypass	100 sheets; A6–A4; custom sizes 60–210 gsm
Automatic duplexing	A4; 60–210 gsm
Output capacity	Max.: 150 sheets
Copy/print volume (monthly)	Rec.: 6,500 pages Max. ² : 120,000 pages
Toner lifetime	Black 5,000 pages; CMY 5,000 pages
Imaging unit lifetime	Black 25,000 pages; CMY 25,000 pages
Power consumption	220–240 V / 50/60 Hz Less than 1.2 kW (system)
System dimensions	447 x 544 x 500 mm (W x D x H)
System weight	Approx. 30 kg
Fax	Super G3 (optional)

COPIER SPECIFICATIONS

Copying process	Electrostatic laser copy, tandem, indirect
Toner system	Simitri® HD polymerised toner
Warm-up time	Approx. 38 sec. ³
Copy resolution	600 x 600 dpi
Multi-copy	1–99
Original format	A6–A4
Magnification	25–400% in 1% steps; auto-zooming
Copy functions	Duplex copy; ID card copy; 2-in-1; 4-in-1; poster; density adjustments

PRINTER SPECIFICATIONS

Print resolution	1,200 x 1,200 dpi
Page description language	PCL 5e/c PostScript 3 PDF 1.7 XPS ¹
Operating systems	Windows VISTA (32/64) Windows 7 (32/64) Windows 8 (32/64) Windows Server 2003/2008 (32/64) Windows Server 2012 (64) Macintosh OS X 10.x Linux Citrix
Printer fonts	80 PCL Latin 137 PostScript 3 Latin
Print functions	Direct print ¹ of TIFF, XPS ¹ , PDF and JPEG; XPS ¹ and OOXML (DOCX, XLSX, PPTX); secure print ¹ ; combination; n-up; poster; overlay; watermark

SCANNER SPECIFICATIONS

Scan speed	Up to 30 ipm (mono/colour)
Scan resolution	Max.: 600 x 600 dpi
Scan modes	Scan-to-eMail (Scan-to-Me) Scan-to-SMB (Scan-to-Home) Scan-to-FTP Scan-to-USB Scan-to-HDD ¹ Scan-to-DPWS Network TWAIN scan
File formats	TIFF; PDF; Compact PDF; JPEG; XPS ¹
Scan destinations	250 (shared with fax); LDAP support

¹ 1 HD-P06 optional hard disk enables secure printing, proof-then-print, print & hold, job storing, XPS emulation, i-Option support and ID card reader support

² If the maximum volume is reached within a period of one year, then a maintenance cycle must be performed.

³ Warm up time may vary depending on the operating environment and usage

bizhub C3351/C3851

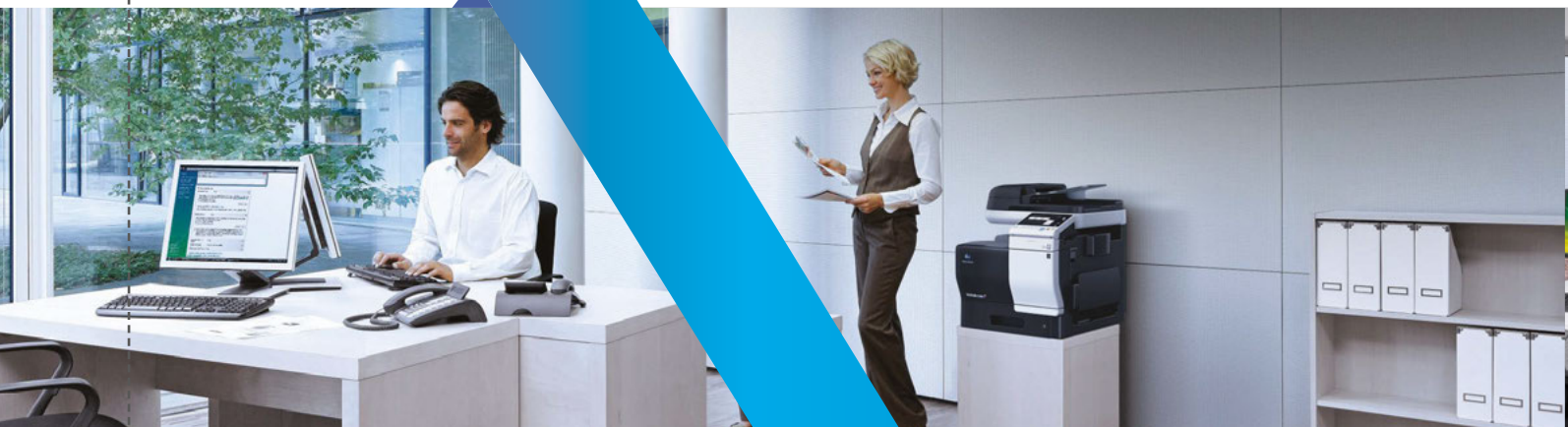

- Mono/Colour
- Up to 33/38ppm A4

High quality, cost-effective
colour and B&W printing

Printer fits any office space

TECHNICAL SPECIFICATIONS

SYSTEM SPECIFICATIONS

System memory (std/max)	2 GB/4 GB
System hard disk	250 GB (standard)
Interface (opt)	10/100/1,000-Base-T Ethernet; USB 2.0; Wi-Fi 802.11b/g/n
Network protocols	TCP/IP (IPv4/IPv6); SMB; LPD; IPP; SNMP; HTTP; HTTPS
Frame types	Ethernet 802.2; Ethernet 802.3; Ethernet II; Ethernet SNAP
Automatic document feeder	Up to 50 originals; A5–A4; 50–128 g/m ² ; reverse automatic document feeder
Printable paper size	A6–A4; customised paper sizes
Printable paper weight	60–210 g/m ²
Paper input capacity (standard/max)	650 sheets/1,650 sheets
Paper tray input (std)	550 sheets; A6–A4, 60–210 g/m ²
Paper tray input (opt)	2 x 500 sheets; A4, 60–90 g/m ²
Manual bypass	100 sheets; A6–A4; custom sizes; 60–210 g/m ²
Automatic duplexing	A4; 60–210 g/m ²
Finishing modes (opt)	Staple (off-line)
Output capacity	Max.: 250 sheets
Stapling (optional)	Max.: 20 sheets (off-line stapling)
Copy/print volume (monthly)	Rec.: 6,500 pages Max. ¹ : 96,000 pages
Toner lifetime	K: 13,000; CMY: 12,000 pages
Imaging unit lifetime	K: 60,000; CMY: 50,000 pages
Power consumption	220–240 W/50/60 Hz; Less than 1.7 kW
System dimensions (WxDxH)	555 x 584 x 603 mm
System weight	Approx. 49.2 kg (without options)
Fax	Super G3 (optional)

COPIER SPECIFICATIONS

Copying process	Electrostatic laser copy; tandem; indirect
Toner system	Simtri® HD polymerised toner
1st copy out time	8.1/9.1 sec.
Warm-up time	Approx. 20 sec. ²
Copy resolution	600 x 600 dpi
Original format	Max. A4
Magnification	25–400% in 0.1% steps; auto-zooming
Copy functions	Electronic sorting; multi-job; adjustments (contrast, sharpness, image density); proof copy; interrupt mode; colour mode; separate scan; sort/group; combination; original selection; ID card copy; 2-in-1; 4-in-1

PRINTER SPECIFICATIONS

Print resolution	600 x 600 dpi 1,200 x 1,200 dpi (reduced speed)
Page description language	PCL 6 (XL 3.0); PCL 5c; PostScript 3 (CPSI 3016); XPS
Operating systems	Windows Vista (32/64) Windows 7 (32/64) Windows 8 (32/64) Windows 10 (32/64) Windows Server 2008 (32/64) Windows Server 2008 R2 Windows Server 2012 Windows Server 2012 R2 Windows Server 2016 Macintosh OS X 10.x Linux Unix Citrix
Print functions	Direct print of TIFF; XPS; PDF (v1.7) and OOXML (DOCX, XLSX, PPTX); secure print; combination; n-up; poster; booklet page order; watermark
Mobile Printing	AirPrint (iOS); Mopria (Android); Google Cloud Print (optional); Wi-Fi Direct (optional); Konica Minolta Print Service (Android); PageScope Mobile (iOS/Android/Windows 10 Mobile)

SCANNER SPECIFICATIONS

Scan speed	Up to 35 ipm (mono/colour)
Scan resolution	Up to 600 x 600 dpi
Scan modes	Scan-to-eMail (Scan-to-Me) Scan-to-SMB (Scan-to-Home) Scan-to-FTP Scan-to-HDD Scan-to-USB Scan-to-WebDAV Scan-to-URL Network TWAIN scan
File formats	JPEG; TIFF; PDF; PDF/A (1b); Compact PDF; encrypted PDF; XPS

¹ If the maximum volume is reached within a period of one year, then a maintenance cycle must be performed

² Warm-up time may vary depending on the operating environment and usage

bizhub C227/C287



Full mobile connectivity

- Mono/Colour
- Up to 22/28ppm A4

Productivity features to
economically speed
your output

TECHNICAL SPECIFICATIONS

SYSTEM SPECIFICATIONS

System memory	2,048 MB (standard)
System hard disk	250 GB (standard)
Interface	10-Base-T/100-Base-T/1,000-Base-T Ethernet; USB 2.0, Wi-Fi 802.11b/g/n (optional)
Network protocols	TCP/IP (FTP; SMB; SMTP; WebDAV) (IPv4/IPv6)
Frame types	Ethernet 802.2; Ethernet 802.3; Ethernet II; Ethernet SNAP
Automatic document feeder	Up to 100 originals; A6-A3; 35-128 gsm RADF optional available
Printable paper size	A5-A3; A6S; banner paper; Thick Paper X/Y size input range: Width: 90-297 mm; Length: 139.7-431.8 mm
Printable paper weight	60-256 gsm
Paper input capacity	Standard: 1,100 sheets Max.: 3,600 sheets
Tray 1	500 sheets; A5-A4; 60-256 gsm
Tray 2	500 sheets; A5-A3; 60-256 gsm
Tray 3 (optional)	500 sheets; A5-A3; 60-256 gsm
Tray 4 (optional)	2 x 500 sheets; A5-A3; 60-256 gsm
Large capacity tray (opt)	2,500 sheets; A4; 60-256 gsm
Manual bypass	100 sheets; A6-A3; 60-256 gsm
Automatic duplexing	A5-A3; 60-256 gsm
Finishing modes (optional)	Offset; group; sort; staple; punch; centre-fold; letter fold; booklet
Output capacity	Max.: 3,300 sheets (with finisher)
Output capacity	Max.: 250 sheets (without finisher)
Stapling	Max.: 50 sheets or 48 sheets + 2 cover sheets (up to 209 gsm)
Stapling output capacity	Max.: 1,000 sheets
Letter fold	Up to 3 sheets
Letter fold capacity	Max.: 30 sheets (tray); unlimited
Booklet	Max.: 20 sheets or 19 sheets + 1 cover sheet (up to 209 gsm)
Booklet output capacity	Max.: 100 sheets
Copy/print volume (monthly)	Rec.: 10,000 pages Max.: 19,000 pages
Toner lifetime	Black 24,000 pages; CMY 21,000 pages
Imaging unit lifetime	Black 80,000 pages/600,000 pages (Drum/Developer) CMY 70,000 pages (Imaging Unit)
Power consumption	220-240 V / 50/60 Hz; Less than 1.6 kW (system)
System dimensions	585 x 660 x 735 mm (main body) (W x D x H)
System weight	Approx. 72 kg (without options/toner)
Fax	G3 (optional)

¹ If the maximum volume is reached within a period of one year, then a maintenance cycle must be performed

² Warm-up time may vary depending on the operating environment and usage

COPIER SPECIFICATIONS

Copying process	Electrostatic laser copy; indirect
Toner system	Simitri® HD polymerised toner
Copy/print speed A4	Up to 22 ppm
Copy/print speed A3	Up to 14 ppm
Autoduplex speed A4	Up to 22 ppm
1st copy out time	6.8 sec/8.4 sec (mono/colour)
Warm-up time	Approx. 20 sec. ²
Copy resolution	600 x 600 dpi
Original format	A5-A3
Magnification	25-400% in 0.1% steps; auto-zooming
Copy functions	Chapter; cover and page insertion; proof copy; adjustment test print; job setting memory; poster mode; image repeat; overlay (optional, with UK-211); stamping; copy protection

PRINTER SPECIFICATIONS

Print resolution	1,800 (equivalent) x 600 dpi
Page description language	PCL 6 (PCL 5c + XL 3.0); PostScript 3 (CPSI 3016); XPS
Operating systems	Windows VISTA (32/64) Windows 7 (32/64) Windows 8 (32/64) Windows 8.1 (32/64) Windows 10 (32/64) Windows Server 2008/2008 R2 (32/64) Windows Server 2012/2012 R2 (64) Macintosh OS X 10.x Linux
Print functions	Direct print of PCL; PS; TIFF; XPS; PDF (v1.4); encrypted PDF files and OOXML (DOCX; XLSX; PPTX); mixmedia and mixplex; Easy Set job programming; overlay; watermark; carbon copy print; copy protection
Mobile Printing	AirPrint (iOS); Mopria (Android); Google Cloud Print (optional); WiFi Direct (optional); Konica Minolta Print Service (Android); PageScope Mobile (iOS & Android); NFC Authentication and Pairing (Android)

SCANNER SPECIFICATIONS

Scan speed (with optional ADF)	Up to 45 ipm (mono/colour)
Scan resolution	Max.: 600 x 600 dpi
Scan modes	Scan-to-eMail (Scan-to-Me) Scan-to-SMB (Scan-to-Home) Scan-to-FTP Scan-to-Box Scan-to-USB Scan-to-WebDAV Scan-to-DPWS Network TWAIN scan
File formats	TIFF; PDF; Compact PDF; JPEG; XPS; Compact XPS; DOCX; XLSX; searchable PDF; PDF/A; linearized PDF

bizhub C258/C308/C368



- Mono/Colour
- Up to 25/30/36ppm A4

The best of both worlds:
Digital and paper based

TECHNICAL SPECIFICATIONS

SYSTEM SPECIFICATIONS

System memory	2,048 MB (standard)
System hard disk	250 GB (standard)
Interface	10-Base-T/100-Base-T/1,000-Base-T Ethernet; USB 2.0 Wi-Fi 802.11b/g/n (optional)
Network protocols	TCP/IP (IPv4 / IPv6); IPX/SPX; NetBEUI; AppleTalk (EtherTalk); SMB; LPD; IPP; SNMP; HTTP
Frame types	Ethernet 802.2; Ethernet 802.3; Ethernet II; Ethernet SNAP
Automatic document feeder (optional)	Up to 100 originals; A6-A3; 35-163 gsm RADF or Dualscan ADF available
Printable paper size	A6-SRA3, customised paper sizes; banner paper max. 1,200 x 297 mm
Printable paper weight	52-300 gsm
Paper input capacity	Standard: 1,150 sheets Max.: 6,650 sheets
Tray 1	500 sheets, A5-A3, 52-256 gsm
Tray 2	500 sheets, A5-SRA3, 52-256 gsm
Tray 3 (optional)	1 x 500 sheets, A5-A3, 52-256 gsm
Tray 4 (optional)	2 x 500 sheets, A5-A3, 52-256 gsm
Large capacity tray (opt)	2,500 sheets, A4, 52-256 gsm
Large capacity tray LU-302 (optional)	3,000 sheets, A4, 52-256 gsm
Manual bypass	150 sheets, A6-SRA3, custom sizes, banner, 60-300 gsm
Automatic duplexing	A5-SRA3; 52-256 gsm
Finishing modes (optional)	Offset; group; sort; staple; punch; centre-fold; letter fold; booklet
Output capacity	Max.: 3,300 sheets (with finisher)
Output capacity	Max.: 250 sheets (without finisher)
Stapling	Max.: 50 sheets or 48 sheets + 2 cover sheets (up to 209 gsm)
Stapling output capacity	Max. 1,000 sheets
Letter fold	Up to 3 sheets
Letter fold capacity	Max.: 30 sheets (tray); unlimited
Booklet	Max.: 20 sheets or 19 sheets + 1 cover sheet (up to 209 gsm)
Booklet output capacity	Max.: 100 sheets (tray); unlimited
Copy/print volume (monthly)	Rec.: 16,000 pages Max.: 100,000 pages
Toner lifetime	Black 28,000 pages; CMY 26,000 pages
Imaging unit lifetime	Black 120,000 pages/600,000 pages (Drum/Developer) CMY 75,000 pages/600,000 pages (Drum/Developer)
Power consumption	220-240 V / 50/60 Hz Less than 1.5 kW (system)
System dimensions	615 x 685 x 771 mm (excl. ADF and lower paper tray unit) (W x D x H)
System weight	Approx. 85 kg
Fax	Super G3 (optional)

COPIER SPECIFICATIONS

Copying process	Electrostatic laser copy, tandem, indirect
Toner system	Simitri® HD polymerised toner
Autoduplex speed A4	Up to 30 ppm (mono/colour)
1st copy out time	5.6 sec. 7.3 sec. (mono/colour)
Warm-up time	Approx. 20 sec. ²
Copy resolution	600 x 600 dpi
Original format	A5-A3
Magnification	25-400% in 0.1% steps; auto-zooming
Copy functions	Chapter; cover and page insertion; proof copy (print and screen); adjustment test print; digital art functions; job setting memory; poster mode; image repeat; overlay (optional stamping; copy protection)

PRINTER SPECIFICATIONS

Print resolution	1,800 x 600 dpi; 1,200 x 1,200 dpi
Page description language	PCL 6 (XL 3.0); PCL 5c; PostScript 3 (CPSI 3016); XPS
Operating systems	Windows VISTA (32/64), Windows 7 (32/64) Windows 8 (32/64), Windows 10 (32/64) Windows Server 2008 (32/64), Windows Server 2008 R2 Windows Server 2012, Windows Serv (mono/colour) Macintosh OS X 10.x, Unix, Linux, Citrix Direct print of PCL, PS, TIFF, XPS, PDF (v1.7), encrypted PDF files and OOXML (DOCX, XLSX, PPTX); mixmedia and mixplex; Easy Set job programming; overlay; watermark; copy protection; carbon copy print
Print functions	
Mobile Printing	AirPrint (iOS), Mopria (Android), Google Cloud Print (optional) WiFi Direct (optional), Konica Minolta Print Service (Android) PageScope Mobile (iOS & Android); NFC Authentication and Pairing (Android)

SCANNER SPECIFICATIONS

Scan speed (with optional DF-704)	Up to 160 ipm (mono/colour)
Scan resolution	Max.: 600 x 600 dpi
Scan modes	Scan-to-eMail (Scan-to-Me), Scan-to-SMB (Scan-to-Home) Scan-to-FTP, Scan-to-Box, Scan-to-USB, Scan-to-WebDAV Scan-to-DPWS, Network TWAIN scan
File formats	JPEG; TIFF; PDF; PDF/A 1a and 1b (optional); compact PDF encrypted PDF; searchable PDF (optional); XPS; compact XF PPTX; searchable DOCX/XLSX/PPTX (optional)
Scan destinations	2,100 (single + group); LDAP support
Scan functions	Annotation (text/time/date) for PDF; up to 400 job program real-time scan preview

¹ If the maximum volume is reached within a period of one year, then a maintenance cycle must be performed

² Warm-up time may vary depending on the operating environment and usage

bizhub C458/C558/C658



- Mono/Colour
- Up to 45/55/65ppm A4

The perfect platform for the productive office, with large touch-screen display, high capacity dual scan and full mobile connectivity

TECHNICAL SPECIFICATIONS

SYSTEM SPECIFICATIONS

System memory (std/max)	4,096 MB
System hard disk	250 GB (standard)
Interface	10/100/1,000-Base-T Ethernet; USB 2.0; Wi-Fi 802.11b/g/n (optional)
Network protocols	TCP/IP (IPv4 / IPv6); IPX/SPX; NetBEUI; AppleTalk (EtherTalk); SMB; LPD; IPP; SNMP; HTTP
Frame types	Ethernet 802.2; Ethernet 802.3; Ethernet II; Ethernet SNAP
Automatic document feeder (std/max)	Up to 300 originals; A6-A3; 35-210 g/m ² ; Dualscan ADF
Printable paper size	A6-SRA3; customised paper sizes; banner paper max. 1,200 x 297 mm
Printable paper weight	52-300 g/m ²
Paper input capacity (standard/max)	1,150 sheets/6,650 sheets
Paper tray input (standard)	1x 500 sheets; A5-A3; 52-256 g/m ²
Paper tray input (optional)	1x 500 sheets; A5-A3; 52-256 g/m ² ; 1x 500 sheets; A5-A3; 52-256 g/m ² ; 1x 2,500 sheets; A4; 52-256 g/m ²
Large capacity tray (optional)	1x 3,000 sheets; A4; 52-256 g/m ² ; 1x 2,500 sheets; A4-SRA3; 52-256 g/m ²
Manual bypass	150 sheets; A6-SRA3; custom sizes; banner; 60-300 g/m ²
Automatic duplexing	A5-SRA3; 52-256 g/m ²
Finishing modes (optional)	Offset; group; sort; staple; punch; post insertion; z-fold; centre-fold; letter fold; booklet
Output capacity (std)	Max. 250 sheets
Output capacity (opt)	Max. 3,300 sheets
Stapling	Max. 100 sheets or 94 sheets + 2 cover sheets (up to 209 g/m ²)
Stapling output capacity	Max. 1,000 sheets
Letter fold	Max. 3 sheets
Letter fold capacity	Max. 30 sheets; unlimited (without tray)
Booklet	Max. 20 sheets or 19 sheets + 1 cover sheet (up to 209 g/m ²)
Booklet output capacity	Max. 100 booklets; unlimited (without tray)
Copy/print volume (monthly)	Rec. 30,000 pages; Max. 150,000 pages ¹
Toner lifetime	Black up to 28,000 pages; CMY up to 26,000 pages
Imaging unit lifetime	Black up to 135,000/600,000 pages (drum/developer); CMY up to 100,000/600,000 pages (drum/developer)
Power consumption	220-240 V / 50/60 Hz; Less than 1.6 kW
System dimension (W x D x H)	615 x 693 x 961 mm (without options); 615 x 693 x 1,200 mm (with desk/tray)
System weight	Approx. 110 kg (without options)
Fax	Super G3 (optional)

COPIER SPECIFICATIONS

Imaging technology	Laser
Toner technology	Simitri® HD polymerised toner/Polymerised toner
Copy/print speed A4	Up to 55 ppm
Copy/print speed A3	Up to 27 ppm
Autoduplex speed A4	Up to 55 ppm
1st copy out time A4	3.5 sec.
Warm-up time	Approx. 22 sec.
Copy resolution	600 x 600 dpi
Original format	A5-A3; custom sizes
Magnification	25-400% in 0.1% steps; auto-zooming
Copy function	Chapter; cover and page insertion; proof copy (print and screen); adjustment test print; digital art functions; job setting memory; poster mode; image repeat; overlay (optional); stamping; copy protection

PRINTER SPECIFICATIONS

Print resolution	1,800 (equivalent) x 600 dpi; 1,200 x 1,200 dpi
Page description language	PCL 6 (XL 3.0); PCL 5c; PostScript 3 (CPSI 3016); XPS
Operating System	Windows VISTA (32/64); Windows 7 (32/64); Windows 8 (32/64); Windows 10 (32/64); Windows Server 2008 (32/64); Windows Server 2008 R2; Windows Server 2012; Windows Server 2012 R2; Macintosh OS 10.x; Unix; Linux; Citrix
Print functions	Direct print of PCL, PS, TIFF, XPS, PDF (v1.7), encrypted PDF files and OOXML (DOCX, XLSX, PPTX); mixmedia and mixplex; "Easy Set" job programming; overlay; watermark; copy protection; carbon copy print
Mobile printing	AirPrint (iOS), Mopria (Android), Google Cloud Print (optional), WiFi Direct (optional), Konica Minolta Print Service (Android), PageScope Mobile (iOS, Android & Windows 10 Mobile); Mobile Authentication and Pairing (Android & iOS)

SCANNER SPECIFICATIONS

Scan speed (mono/colour)	Up to 80 ipm in simplex Up to 160 ipm in duplex
Scan resolution	Up to 600 x 600 dpi
Scan modes	Scan-to-eMail (Scan-to-Me); Scan-to-SMB (Scan-to-Home); Scan-to-FTP; Scan-to-Box; Scan-to-USB; Scan-to-WebDAV; Scan-to-DPWS; Scan-to-URL; TWAIN scan
File formats	JPEG; TIFF; PDF; compact PDF; encrypted PDF; XPS; compact XPS; PPTX Optional: searchable PDF; PDF/A 1a and 1b; searchable DOCX/PPTX/XLSX

¹ If the maximum volume is reached within a period of one year, then a maintenance cycle must be performed

bizhub C759



- Mono/Colour
- Speed A4/A3: colour 65/32ppm
- Speed A4/A3: black & white 75/37ppm

Improved user-device interaction
and productivity

TECHNICAL SPECIFICATIONS

SYSTEM SPECIFICATIONS

Panel size/resolution	10.1" / 1024 x 600
System memory (standard/max)	4,096 MB
System hard disk	250 GB (standard)
Interface	10/100/1,000-Base-T Ethernet; USB 2.0; Wi-Fi 802.11b/g/n (optional)
Network protocols	TCP/IP (IPv4 / IPv6); SMB; LPD; IPP; SNMP; HTTP
Automatic document feeder	Up to 300 originals; A6-A3; 35-210 g/m ² ; Dualscan ADF
Printable paper size	A6-SRA3; customised paper sizes; banner paper max. 1,200 x 297 mm
Printable paper weight	52-300 g/m ²
Paper input capacity (standard/max)	3,650 sheets/6,650 sheets
Paper tray input (standard)	1 x 500 sheets; A5-SRA3; custom sizes; 52-256 g/m ² 1 x 500 sheets; A5-SRA3; custom sizes; 52-256 g/m ² 1 x 1,000 sheets; A5-A4; 52-256 g/m ² 1 x 1,500 sheets; A5-A4; 52-256 g/m ²
Large capacity tray (optional)	1 x 3,000 sheets; A4; 52-256 g/m ² ; 1 x 2,500 sheets; A4-SRA3; 52-256 g/m ²
Manual bypass	150 sheets; A6-SRA3; custom sizes; banner; 52-300 g/m ²
Automatic duplexing	A6 portrait; A5-SRA3; 52-256 g/m ²
Finishing modes (optional)	Offset; group; sort; staple; punch; post insertion; z-fold; half-fold; letter fold; booklet
Output capacity (standard)	Max. 250 sheets
Output capacity (optional)	Max. 3,300 sheets
Stapling	Max. 100 sheets or 94 sheets + 2 cover sheets (up to 209 g/m ²)
Stapling output capacity	Max. 1,000 sheets
Letter fold	Max. 3 sheets
Letter fold capacity	Max. 30 sheets; unlimited (without tray)
Booklet	Max. 20 sheets or 19 sheets + 1 cover sheet (up to 209 g/m ²)
Booklet output capacity	Max. 100 booklets; unlimited (without tray)
Copy/print volume (monthly)	Rec. 80,000 pages; Max. 300,000 pages ¹
Toner lifetime	Black up to 48,900 pages; CMY up to 33,200 pages
Imaging unit lifetime	Black up to 300,000/1,200,000 pages (drum/developer); CMY up to 200,000 pages (imaging unit)
Power consumption	220-240 V / 50/60 Hz; Less than 2.1 kW
System dimension (W x D x H)	670 x 938 x 1232 mm (with desk/tray)
System weight	Approx. 219 kg (without options)
Fax	Super G3 (optional)

COPIER SPECIFICATIONS

Imaging technology	Laser
Toner technology	Simitri® HD polymerised toner/Polymerised toner
Copy/print speed A4 (mono/colour)	Up to 75/65
Copy/print speed A3 (mono/colour)	Up to 37/32
Autoduplex speed A4 (mono/colour)	Up to 75/65
1st copy out time A4 (mono/colour)	3.6/4.9 sec.
Warm-up time	Approx. 22 sec. in mono; 35 sec in colour ²
Copy resolution	600 x 600 dpi
Original format	A5-A3; custom sizes
Magnification	25-400% in 0.1% steps; auto-zooming
Copy function	Chapter; cover and page insertion; proof copy (print and screen); adjustment test print; digital art functions; job setting memory; poster mode; image repeat; overlay (optional); stamping; copy protection

PRINTER SPECIFICATIONS

Print resolution	1,800 (equivalent) x 600 dpi; 1,200 x 1,200 dpi
Page description language	PCL 6 (XL 3.0); PCL 5; PostScript 3 (CPSI 3016); XPS
Operating systems	Windows 7 (32/64); Windows 8/8.1 (32/64); Windows 10 (32/64); Windows Server 2008 (32/64); Windows Server 2008 R2; Windows Server 2012; Windows Server 2012 R2; Windows Server 2016; Macintosh OS X 10.8 or later; Unix; Linux; Citrix
Print functions	Direct print of PCL, PS, TIFF, XPS, PDF (v1.7), encrypted PDF files and OOXML (DOCX, XLSX, PPTX); mixmedia and mixplex; "Easy Set" job programming; overlay; watermark; copy protection; carbon copy print
Mobile printing	AirPrint (iOS), Mopria (Android), Konica Minolta Print Service (Android), Konica Minolta Mobile Print (iOS, Android & Windows 10 Mobile); Mobile Authentication and Pairing (Android & iOS) optional: Google Cloud Print; Wifi Direct

SCANNER SPECIFICATIONS

Scan speed (mono/colour)	Up to 120/120 ipm in simplex Up to 240/240 ipm in duplex
Scan resolution	Up to 600 x 600 dpi
Scan modes	Scan-to-eMail (Scan-to-Me); Scan-to-SMB (Scan-to-Home); Scan-to-FTP; Scan-to-Box; Scan-to-USB; Scan-to-WebDAV; Scan-to-DPWS; Scan-to-URL; TWAIN scan
File formats	JPEG; TIFF; PDF; compact PDF; encrypted PDF; XPS; compact XPS; PPTX optional: searchable PDF; linearised PDF; PDF/A 1a and 1b; searchable DOCX/PPTX/XLSX

¹ If the maximum volume is reached within a period of one year, then a maintenance cycle must be performed

² Warm-up time may vary depending on the operating environment and usage

bizhub 3622/4422



- Black & white
- Up to 36/44ppm A4

Print and scan at super-fast speed
without sacrificing quality

TECHNICAL SPECIFICATIONS

SYSTEM SPECIFICATIONS

Panel size/resolution	2.4" / 320 x 240
System memory	1 GB (standard)
Interface	10-Base-T/100-Base-TX/1,000-Base-T Ethernet; USB 2.0; Wi-Fi 802.11b/g/n
Network protocols	TCP/IP (IPv4 / IPv6); UDP; AppleTalk; SMB; LPD; IPP; SNMP; HTTP/S
Automatic document feeder	Up to 50 originals; A6-A4; 52-120 g/m ² bizhub4422: RADF
Printable paper size	A6-A4, customised paper sizes
Printable paper weight	60-216 g/m ²
Paper input capacity	Standard: 350 sheets; Max.: 900 sheets
Paper tray input (standard)	250 sheets, A6-A4, 60-120 g/m ²
Paper tray input (optional)	250/550 sheets; A5-A4; 60-120 g/m ²
Manual bypass	100 sheets, A6-A4, custom sizes, 60-216 g/m ²
Automatic duplexing	A4; 60-90 g/m ²
Output capacity	Max.: 150 sheets
Copy/print volume (monthly)	Rec.: 3,600 pages; Max. ¹ : 50,000 pages
Toner lifetime	15,000 pages
Imaging unit lifetime	60,000 pages
Power consumption	220-240 V / 50/60 Hz; Less than 550 W
System dimensions (W x D x H)	399 x 429.5 x 467 mm
System weight	Approx. 19.4 kg
Fax	Super G3 (optional)

PRINTER SPECIFICATIONS

Print resolution	1,200 x 1,200 dpi
Page description language	PCL 5/6; PostScript 3; XPS
Operating systems	Windows 7 (32/64); Windows 8/8.1 (32/64); Windows 10 (32/64); Windows Server 2008 (32/64); Windows Server 2008 R2; Windows Server 2012; Windows Server 2012 R2; Windows Server 2016; Macintosh OS X 10.9 or later; Linux; Citrix
Print functions	Duplex; n-up; watermark; cover sheet; electronic sorting; secure print
Mobile Printing	AirPrint (iOS), Mopria (Android), Google Cloud Print, Konica Minolta Mobile Print (iOS, Android & Windows 10 Mobile), Konica Minolta Print Service (Android), Wifi Direct

COPIER SPECIFICATIONS

Copying process	Electrostatic laser
Copy/print speed A4	Up to 36 ppm
Autoduplex copy/print speed A4	Up to 19 ppm
1st copy out time	6.0 sec.
Copy resolution	600 x 600 dpi
Multicopy	1-999
Original format	A6-A4
Magnification	25-400%
Copy functions	Duplex; 2-in-1; 4-in-1; page insertion; overlay; electronic sorting; ID copy; margin shift; background removal

SCANNER SPECIFICATIONS

Scan speed	Up to 42/20 ipm
Scan resolution	Max.: 600 x 600 dpi
Scan modes	Scan-to-eMail; Scan-to-FTP; Network TWAIN scan
File formats	PDF; TIFF; JPEG; XPS
Scan function	Up to 500 job programs

SYSTEM FEATURES

Security	SNMPv3; HTTPS; TCP/UDP port disabling; IEEE 802.1x support (wireless); secure print (print hold/PIN); certificate management; SMTP authentication
Software	PageScope Net Care Device Manager

¹ If the maximum volume is reached within a period of one year, then a maintenance cycle must be performed





bizhub 4052/4752



- Black & white
- Up to 40/47ppm A4

Offering high productivity, great environmental performance whilst saving money

FUNCTIONALITY

 <p>Copying</p>	 <p>Printing</p>	 <p>Scanning</p>	 <p>Faxing</p>
<ul style="list-style-type: none"> – Black & white 	<ul style="list-style-type: none"> – Black & white – PCL/PS – Local/Network – USB 	<ul style="list-style-type: none"> – Colour – Black & white – Scan-to-eMail – Scan-to-SMB – Scan-to-FTP 	<ul style="list-style-type: none"> – Scan-to-HDD – Scan-to-USB – Scan-to-WebDAV – TWAIN Network – Super G3 Fax – PC-Fax – i-Fax – IP-Fax

TECHNICAL SPECIFICATIONS

SYSTEM SPECIFICATIONS

System memory	2 GB (standard)
System hard disk	320 GB (standard)
Interface	Ethernet 10-Base-T/100-Base-TX/1,000-Base-T; USB 1.1; USB 2.0; Wi-Fi 802.11b/g/n (optional)
Network protocols	TCP/IP (IPv4 / IPv6); SMB; LPD; IPP; SNMP; HTTP; DHCP; DNS
Frame types	Ethernet 802.2; Ethernet 802.3; Ethernet II; Ethernet SNAP
Automatic document feeder	Up to 50 originals; A6–A4; 52–120 gsm automatic dualscan document feeder
Printable paper size	A6–A4, customised paper sizes
Printable paper weight	60–163 gsm
Paper input capacity	Standard: 650 sheets Max.: 2,300 sheets
Tray 1	550 sheets; A6–A4; 60–120 gsm
Tray 2 (optional)	250/550 sheets; A5–A4; 60–120 gsm
Manual bypass	100 sheets; A6–A4, 60–163 gsm; custom sizes
Automatic duplexing	A4; 60–90 gsm
Finishing modes (opt)	Group/sort; staple (optional)
Output capacity (with finisher)	Max.: 250 sheets
Stapling	Max.: 20 sheets per set
Stapling output capacity	Max.: 250 sheets
Copy/print volume (monthly)	Rec.: 6,500 pages Max.*: 100,000 pages
Toner lifetime	20,000 pages
Imaging unit lifetime	60,000 pages
Power consumption	220–240 V / 50/60 Hz Less than 1.1 kW
System dimensions	489 x 482 x 561 mm (W x D x H)
System weight	Approx. 24 kg

PRINTER SPECIFICATIONS

Print resolution	1,200 x 1,200 dpi
Page description language	PCL 5/6 PostScript 3 XPS
Operating systems	Windows Vista (32/64) Windows 7 (32/64) Windows 8 (32/64) Windows 10 (32/64) Windows Server 2008 (32/64) Windows Server 2008 R2 Windows Server 2012 Windows Server 2012 R2 Macintosh OS X 10.x Linux
Print functions	Direct print of PCL; PS; TIFF; XPS; PDF (v1.7); encrypted PDF files and OOXML (DOCX, XLSX, PPTX); secure print; watermark
Mobile Printing	AirPrint (iOS), Mopria (Android), Google Cloud Print (optional), WiFi Direct (optional), Konica Minolta Print Service (Android), PageScope Mobile (iOS & Android)

* If the maximum volume is reached within a period of one year, then a maintenance cycle must be performed

bizhub 227/287/367

- Black & white
- Up to 22/28/36ppm A4

Combines advanced technology and operator convenience

TECHNICAL SPECIFICATIONS

SYSTEM SPECIFICATIONS

System memory	2,048 MB (standard)
System hard disk	250 GB (standard)
Interface	10-Base-T/100-Base-T/1,000-Base-T Ethernet; USB 2.0
Network protocols	TCP/IP (FTP; SMB; SMTP; WebDAV) (IPv4/IPv6)
Frame types	Ethernet 802.2; Ethernet 802.3; Ethernet II; Ethernet SNAP
Automatic document feeder	Up to 100 originals; A6-A3; 35-128 gsm RADF optional available
Printable paper size	A5-A3; A6S; Thick Paper X/Y size input range: Width: 90-297 mm; Length: 139.7-431.8 mm
Printable paper weight	60-220 gsm
Paper input capacity	Standard: 1,100 sheets Max.: 3,600 sheets
Tray 1	500 sheets; A5-A4; 60-220 gsm
Tray 2	500 sheets; A5-A3; 60-220 gsm
Tray 3 (optional)	500 sheets; A5-A3; 60-220 gsm
Tray 4 (optional)	2 x 500 sheets; A5-A3; 60-220 gsm
Large capacity tray (opt)	2,500 sheets; A4; 60-220 gsm
Manual bypass	100 sheets; A6-A3; custom sizes; 60-220 gsm
Automatic duplexing	A5-A3; 60-209 gsm
Finishing modes (optional)	Offset; group; sort; staple; punch; centre-fold; letter fold; booklet
Output capacity (with finisher)	Max.: 3,300 sheets
Output capacity (without finisher)	Max.: 250 sheets
Stapling	Max.: 50 sheets or 48 sheets + 2 cover sheets (up to 209 gsm)
Stapling output capacity	Max.: 1,000 sheets
Letter fold	Up to 3 sheets
Letter fold capacity	Max.: 30 sheets (tray); unlimited
Booklet	Max.: 20 sheets or 19 sheets + 1 cover sheet (up to 209 gsm)
Booklet output capacity	Max.: 100 sheets (tray); unlimited
Copy/print volume (monthly)	Rec.: 10,000 pages Max. ¹ : 19,000 pages
Toner lifetime	23,000 pages
Imaging unit lifetime	227:80,000; 287&367:110,000 pages/600,000 pages (Drum/Dev)
Power consumption	220-240 V / 50/60 Hz; Less than 1.5 kW (system)
System dimensions (W x D x H)	585 x 660 x 735 mm (Standard configuration of main body)
System weight	Approx. 56.5 kg
Fax	Super G3 (optional)

¹ If the maximum volume is reached within a period of one year, then a maintenance cycle must be performed

² Warm-up time may vary depending on the operating environment and usage

COPIER SPECIFICATIONS

Copying process	Electrostatic laser copy; indirect
Toner system	Simitri® HD polymerised toner
Warm-up time	Approx. 20 sec. ²
Copy resolution	600 x 600 dpi
Original format	A5-A3
Magnification	25-400% in 0.1% steps; auto-zooming
Copy functions	Chapter; cover and page insertion; proof copy (print and screen); adjustment test print; digital art functions; job setting memory; poster mode; image repeat; overlay (optional); stamping

PRINTER SPECIFICATIONS

Print resolution	1,800 (equivalent) x 600 dpi
Page description language	PCL 6 (PCL 5 + XL 3.0); PostScript 3 (CPSI 3016); XPS
Operating systems	Windows VISTA (32/64) Windows Server 2003/2003 R2 Windows 7 (32/64) Windows Server 2008/2008 R2 (32/64) Windows 8 (32/64) Windows Server 2012/2012 R2 (64) Windows 8.1 (32/64) Macintosh OS X 10.x Unix; Linux; Citrix
Print functions	Direct print of PCL; PS; TIFF; XPS; PDF (v1.7); encrypted PDF files and OOXML (DOCX; XLSX; PPTX); mixmedia and mixplex; Easy Set job programming; overlay; watermark; carbon copy print
Mobile Printing	AirPrint (iOS); Mopria (Android); Google Cloud Print (optional); WiFi Direct (optional); Konica Minolta Print Service (Android); PageScope Mobile (iOS & Android); NFC Authentication and Pairing (Android)

SCANNER SPECIFICATIONS

Scan speed (with optional ADF)	Up to 45 ipm (mono/colour)
Scan resolution	Max.: 600 x 600 dpi
Scan modes	Scan-to-eMail (Scan-to-Me) Scan-to-USB Scan-to-SMB (Scan-to-Home) Scan-to-WebDAV Scan-to-FTP Scan-to-DPWS Scan-to-Box Network TWAIN scan
File formats	TIFF; PDF; Compact PDF; JPEG; XPS; Compact XPS; DOCX; XLSX; searchable PDF; PDF/A; linearized PDF

bizhub 458e/558e



- Black & white A3 multifunctional
- Up to 45/55ppm

Delivers high print quality and yet ensures reduced print spending

TECHNICAL SPECIFICATIONS

SYSTEM SPECIFICATIONS

System memory(std./max.)	4,096 MB
System hard disk	250 GB (standard)
Interface	10/100/1,000-Base-T Ethernet; USB 2.0; Wi-Fi 802.11b/g/n (optional)
Network protocols	TCP/IP (IPv4 / IPv6); NetBEUI; SMB; LPD; IPP; SNMP; HTTP
Automatic document feeder (std.)	Up to 300 originals; A6-A3; 35-163 g/m ² ; Dualscan ADF
Printable paper size	A6-SRA3; customised paper sizes; banner paper max. 1,200 x 297 mm
Printable paper weight	52-300 g/m ²
Paper input capacity (standard/max)	1,150 sheets/6,650 sheets
Paper tray input (standard)	1x 500 sheets; A5-A3; 52-256 g/m ²
Paper tray input (optional)	1x 500 sheets; A5-A3; 52-256 g/m ² ; 2x 500 sheets; A5-A3; 52-256 g/m ² ; 1x 2,500 sheets; A4; 52-256 g/m ²
Large capacity tray (optional)	1x 3,000 sheets; A4; 52-256 g/m ² ; 1x 2,500 sheets; A4-SRA3; 52-256 g/m ²
Manual bypass	150 sheets; A6-SRA3; custom sizes; banner; 60-300 g/m ²
Automatic duplexing	A5-SRA3; 52-256 g/m ²
Finishing modes (optional)	Offset; group; sort; staple; punch; post insertion; half-fold; letter-fold; booklet; z-fold
Output capacity (std.)	Max. 250 sheets
Output capacity (opt.)	Max. 3,300 sheets
Stapling	Max. 100 sheets or 94 sheets + 2 cover sheets (up to 209 g/m ²)
Stapling output capacity	Max. 1,000 sheets
Letter fold	Max. 3 sheets
Letter fold capacity	Max. 30 sheets; unlimited (without tray)
Booklet	Max. 20 sheets or 19 sheets + 1 cover sheet (up to 209 g/m ²)
Booklet output capacity	Max. 100 sheets; unlimited (without tray)
Copy/print vol (monthly)	Rec. 30,000 pages; Max. 200,000 pages ¹
Toner lifetime	Up to 24,400 pages
Imaging unit lifetime	Up to 155,000/600,000 pages (drum/developer)
Power consumption	220-240 V / 50/60 Hz; Less than 2 kW
System dimension	615 x 755 x 921 mm (without options) (W x D x H)
System weight	Approx. 93 kg (without options)
Fax	Super G3 (optional)

¹ If the maximum volume is reached within a period of one year, then a maintenance cycle must be performed

² Warm-up time may vary depending on the operating environment and usage

COPIER SPECIFICATIONS

Imaging technology	Laser
Toner technology	Simitri® HD polymerised toner/Polymerised toner
Copy/print speed A4	Up to 45 ppm
Copy/print speed A3	Up to 22 ppm
Autoduplex speed A4	Up to 45 ppm
1st copy out time A4	4.0 sec.
Warm-up time	Approx. 25 sec. ²
Copy resolution	600 x 600 dpi
Original format	A5-A3; custom sizes
Magnification	25-400% in 0.1% steps; auto-zooming
Copy function	Chapter; cover and page insertion; proof copy (print and screen); adjustment test print; digital art functions; job setting memory; poster mode; image repeat; overlay (optional); stamping; copy protection

PRINTER SPECIFICATIONS

Print resolution	1,800 x 600 dpi; 1,200 x 1,200 dpi
Page description language	PCL 6 (XL 3.0); PCL 5; PostScript 3 (CPSI 3016); XPS
Operating System	Windows VISTA (32/64); Windows 7 (32/64); Windows 8/8.1 (32/64); Windows 10 (32/64); Windows Server 2008 (32/64); Windows Server 2008 R2; Windows Server 2012; Windows Server 2012 R2; Windows Server 2016; Macintosh OS X 10.7 or later; Unix; Linux; Citrix
Print functions	Direct print of PCL, PS, TIFF, XPS, PDF (v1.7), encrypted PDF files and OOXML (DOCX, XLSX, PPTX); mixmedia and mixplex; "Easy Set" job programming; overlay; watermark; copy protection; carbon copy print
Mobile printing	AirPrint (iOS); Mopria (Android); Konica Minolta Print Service (Android); PageScope Mobile (iOS/Android/Windows 10 Mobile); Mobile Authentication and Pairing (iOS/Android) optional: Google Cloud Print; WiFi Direct

SCANNER SPECIFICATIONS

Scan speed (mono/colour)	Up to 80 ipm in simplex Up to 160 ipm in duplex
Scan resolution	Up to 600 x 600 dpi
Scan modes	Scan-to-eMail (Scan-to-Me); Scan-to-SMB (Scan-to-Home); Scan-to-FTP; Scan-to-Box; Scan-to-USB; Scan-to-WebDAV; Scan-to-DPWS; Scan-to-URL; TWAIN scan
File formats	JPEG; TIFF; PDF; compact PDF; encrypted PDF; XPS; compact XPS; PPTX Optional: searchable PDF; PDF/A 1a and 1b; searchable DOCX/PPTX/XLSX

bizhub 658e



- Black & white A3 multifunctional
- Up to 65ppm

Integrates into most working environments, offering a variety of application options

TECHNICAL SPECIFICATIONS

SYSTEM SPECIFICATIONS

System memory	4,096 MB standard
System hard disk	250 GB
Interface	10-Base-T/100-Base-T/1,000-Base-T Ethernet; USB 2.0
Network protocols	TCP/IP (IPv4 / IPv6); IPX/SPX; NetBEUI; AppleTalk (EtherTalk); SMB; LPD; IPP; SNMP; HTTP
Frame types	Ethernet 802.2; Ethernet 802.3; Ethernet II; Ethernet SNAP
Automatic document feeder	Up to 300 originals; A6-A3; 35-210 gsm Dualscan ADF
Printable paper size	A6-SRA3, customised paper sizes; banner paper max. 1,200 x 297 mm
Printable paper weight	52-300 gsm
Paper input capacity	Standard: 3,650 sheets Max.: 6,650 sheets
Tray 1	500 sheets, A5-SRA3, 52-256 gsm
Tray 2	500 sheets, A5-SRA3, 52-256 gsm
Tray 3	1,500 sheets, A4, 52-256 gsm
Tray 4	1,000 sheets, A4, 52-256 gsm
Large capacity tray LU-301 (optional)	3,000 sheets, A4, 52-256 gsm
Large capacity tray LU-204 (optional)	2,500 sheets, A4-SRA3, 52-256 gsm
Manual bypass	150 sheets, A6-SRA3, custom sizes, banner, 52-300 gsm
Automatic duplexing	A5-SRA3; 52-256 gsm
Finishing modes (optional)	Offset; group; sort; staple; punch; post insertion; z-fold; centre-fold; letter fold; booklet
Output capacity	Max.: 3,300 sheets (with finisher)
Output capacity	Max.: 250 sheets (without finisher)
Stapling	Max.: 100 sheets or 94 sheets + 2 cover sheets (up to 209 gsm)
Stapling output capacity	Max.: 1,000 sheets
Letter fold	Up to 3 sheets
Letter fold capacity	Max.: 30 sheets (tray); unlimited
Booklet	Max.: 20 sheets or 19 sheets + 1 cover sheet (up to 209 gsm)
Booklet output capacity	Max.: 100 sheets (tray); unlimited
Copy/print volume (monthly)	Rec.: 80,000 pages; Max.: 215,000 pages
Toner lifetime	48,960 pages
Imaging unit lifetime	300,000 pages/1,200,000 pages (Drum/Developer)
Fax standard	Super G3 (optional)

¹ If the maximum volume is reached within a period of one year, then a maintenance cycle must be performed

² Warm-up time may vary depending on the operating environment and usage

COPIER SPECIFICATIONS

Copying process	Electrostatic laser copy, tandem, indirect
Toner system	Simitri® HD polymerised toner
Autoduplex speed A4	Up to 65ppm
Warm-up time	Approx. 22 sec. ²
Copy resolution	600 x 600 dpi
Original format	A5-A3
Magnification	25-400 % in 0.1 % steps; auto-zooming
Copy functions	Chapter; cover and page insertion; proof copy (print and screen); adjustment test print; digital art functions; job setting memory; poster mode; image repeat; overlay (optional); stamping; copy protection

PRINTER SPECIFICATIONS

Print resolution	1,800 x 600 dpi; 1,200 x 1,200 dpi
Page description language	PCL6 (XL 3.0); PCL 5; PostScript 3 (CPSI 3016); XPS
Operating systems	Windows VISTA (32/64) Windows Server 2008 R2 Windows 7 (32/64) Windows Server 2012 Windows 8 (32/64) Windows Server 2012 R2 Windows Server 2000 Macintosh OS X 10.x Windows Server 2003 (32/64) Unix, Linux, Citrix Windows Server 2008 (32/64)
Print functions	Direct print of PCL, PS, TIFF, XPS, PDF (v1.7), encrypted PDF files and OOXML (DOCX, XLSX, PPTX); mixmedia and mixplex; "Easy Set" job programming; overlay; watermark; copy protection; carbon copy print
Mobile Printing	AirPrint (iOS), Mopria (Android), Google Cloud Print (optional), Konica Minolta Print Service (Android), PageScope Mobile (iOS & Android)

SCANNER SPECIFICATIONS

Scan speed	Up to 180 ipm (mono/colour)
Scan resolution	Max.: 600 x 600 dpi
Scan modes	Scan-to-eMail (Scan-to-Me) Scan-to-USB Scan-to-SMB (Scan-to-Home) Scan-to-WebDAV Scan-to-FTP Scan-to-DPWS Scan-to-Box Network TWAIN scan
File formats	JPEG; TIFF; PDF; PDF/A 1a and 1b (optional); Compact PDF; encrypted PDF; searchable PDF (optional); XPS; compact XPS; PPTX and searchable PPTX (optional); searchable DOCX/XLSX (optional)

bizhub 758/PRO 958



bizhub 758

- Black & white A3 multifunctional
- Up to 75ppm A4

A genuine all-rounder for
large work groups and
in-house print rooms

bizhub PRO 958

- Black & white SRA3
- Up to 95ppm A4

TECHNICAL SPECIFICATIONS

SYSTEM SPECIFICATIONS

Resolution	1,800 x 600 dpi 1,200 x 1,200 dpi
Paper weight	52–300 gsm
Duplex unit	Non-stack type; 52–256 gsm
Paper sizes	A6–SRA3; customised paper sizes; banner paper max. 1,200 x 297 mm
Maximum image area	307 x 437 mm (SRA3); 302 x 448 mm (A3+)
Paper input capacity	Standard: 3,650 sheets Max.: 6,650 sheets
Paper output capacity	Max.: 3,200 sheets
Main unit dimensions (W x D x H)	670 x 820 x 1,232 mm
Main unit weight	200 kg

COPIER SPECIFICATIONS

FCOT	3.1 seconds
Magnification	25–400%, in 0.1% steps

PRODUCTIVITY

A4 Mono - max. per minute	95 ppm
A3 Mono - max. per minute	48 ppm

CONTROLLER

Internal controller	Emperon™
---------------------	----------

SCANNER SPECIFICATIONS

Scan speed A4	Up to 240 ipm; one pass duplex scanning
Scan resolution	600 x 600 dpi
Scan modes	Scan-to-eMail (Scan-to-Me) Scan-to-SMB (Scan-to-Home) Scan-to-FTP Scan-to-Box Scan-to-USB Scan-to-WebDAV Scan-to-DPWS Network TWAIN scan
Scan formats	JPEG; TIFF; PDF; PDF/A 1a and 1b (optional); compact PDF; encrypted PDF; searchable PDF (optional); XPS; compact XPS; PPTX; searchable PPTX (optional); searchable DOCX/XLSX (optional)

ACCESSORIES

Large capacity tray A4	LU-303
Large capacity tray SRA3	LU-205
Staple finisher	FS-536
Punch kit for FS-536	PK-520
Booklet finisher	FS-536SD
Staple finisher	FS-537
Punch kit for FS-537	PK-521
Booklet finisher	FS-537SD
Post inserter for FS-537	PI-507
Job separator for FS-537	JS-602
Z-fold unit for FS-537	ZU-609
Output tray	OT-508
Key pad	KP-101
Working table	WT-506
Upright panel	WT-513
Fax board	FK-516
Keyboard holder	KH-102
USB keyboard connection	EK-610
USB keyboard connection, Bluetooth	EK-611
Biometric authentication	AU-102
Security kit	SC-508
Double feed detection kit	UK-501
Wireless Lan AP	UK-212
Trusted Platform Module (TPM)	LK-115v2
Mount kit for ID card reader	MK-735
Banner tray	BT-C1e
HDD Mirroring	HD-524
i-Option licence PDF/A, PDF encryption, digital signature	LK-102v3
i-Option licence searchable PDF and PPTX	LK-105v4
i-Option licence printing barcode fonts	LK-106
i-Option licence printing of Unicode fonts	LK-107
i-Option licence printing of OCR (A and B) fonts	LK-108
i-Option licence generates various file formats, incl. DOCX and XLSX	LK-110
i-Option licence trusted platform module for protection of data encryption and decryption	LK-115
i-Option licence native ThinPrint client	LK-111
Wireless LAN	SX-BR-4600

- All specifications refer to A4-size paper of 80gsm quality.
- The support and availability of the listed specifications and functionalities varies depending on operating systems, applications and network protocols as well as network and system configurations.
- The stated life expectancy of each consumable is based on specific operating conditions such as page coverage for a particular page size (5% cover age of A4). The actual life of each consumable will vary depending on use and other printing variables including page coverage, page size, media type, continuous or intermittent printing, ambient temperature and humidity.
- Some of the product illustrations contain optional accessories.
- Specifications and accessories are based on the information available at the time of printing and are subject to change without notice.
- Konica Minolta does not warrant that any specifications mentioned will be error-free.
- All brand and product names may be registered trademarks or trademarks of their respective holders and are hereby acknowledged.

bizhub C3100P

bizhub 3602/4402/4702P



Fast, convenient and compact

- Mono/Colour
- Up to 31ppm A4



High productivity and versatility

- Black & white
- Up to 36/44/47ppm A4

TECHNICAL SPECIFICATIONS

PRINTER SPECIFICATIONS

Copying process	Electrostatic laser copy, tandem, indirect
Toner system	Simitri® HD polymerised toner
Print speed A4	Up to 31 ppm (mono/colour)
Autoduplex speed A4	Up to 31 ppm (mono/colour)
1st copy out time	12.9 sec. (mono/colour)
Warm-up time	Approx. 36 sec. ²
Print resolution	1,200 x 1,200 dpi
Page description language	PCL5e/c, PostScript 3 (CPSI 3016), XPS ¹
Operating systems	Windows VISTA (32/64) Windows 7 (32/64) Windows 8 (32/64) Windows Server 2003 (32/64) Windows Server 2008 (32/64) Windows Server 2008 R2 Windows Server 2012 (64) Windows Server 2012 R2 Macintosh OS X 10.x Linux Citrix
Print functions	Direct print ¹ of PDF; JPEG; TIFF; XPS ¹ and OOXML (DOCX; XLSX; PPTX); overlay; watermark; n-up
Mobile Printing	AirPrint (iOS), PageScope Mobile (iOS & Android)

SYSTEM SPECIFICATIONS

System memory	1 GB (standard) 2 GB (optional)
System hard disk	320 GB (optional)
Interface	10-Base-T/100-Base-TX/1,000-Base-T Ethernet; USB 2.0
Network protocols	TCP/IP (IPv4 / IPv6); SMB; LPD; IPP; SNMP; HTTP; HTTPS
Frame types	Ethernet 802.2; Ethernet 802.3; Ethernet II; Ethernet SNAP
Printable paper size	A6-A4; customised paper sizes
Printable paper weight	60-210 gsm
Paper input capacity	Standard: 350 sheets Max.: 850 sheets
Tray 1	250 sheets; A6-A4; 60-210 gsm
Tray 2 (optional)	500 sheets; A4; 60-90 gsm
Manual bypass	100 sheets; A6-A4; custom sizes; 60-210 gsm
Automatic duplexing	A4; 60-210 gsm
Output capacity	Max.: 200 sheets
Copy/print volume	Rec.: 6,500 pages (Monthly)
Toner lifetime	CMYK: 5,000 pages
Imaging unit lifetime	Black: 25,000 pages; CMY: 25,000 pages
Power consumption	220-240 V / 50/60 Hz Less than 1.2 kW (system)
System dimensions	447 x 544 x 350 mm
System weight	Approx. 24 kg

¹ HD-P06 optional hard disk enables secure printing, proof-then-print, print & hold, job storing, XPS emulation, i-Option support and ID card reader support

² Warm-up time may vary depending on the operating environment and usage

TECHNICAL SPECIFICATIONS

PRINTER SPECIFICATIONS

Printing process	Electrostatic laser
Autoduplex speed A4	Up to 14 ppm
Print resolution	1,200 x 1,200 dpi
Page description language	PCL 5/6 PostScript 3, XPS
Operating systems	Windows VISTA (32/64) Windows 7 (32/64) Windows 8 (32/64) Windows 10 (32/64) Windows Server 2008 (32/64) Windows Server 2008 R2 Windows Server 2012 Windows Server 2012 R2 Macintosh OS X 10.x Linux, Citrix
Print functions	Duplex, n-up, watermark, electronic sorting
Mobile Printing	AirPrint (iOS), PageScope Mobile (iOS & Android)

SYSTEM SPECIFICATIONS

System memory	512 MB (standard)
Interface	10-Base-T/100-Base-TX Ethernet USB 2.0, IEEE 1284 Bidirectional Parallel Wi-Fi 802.11b/g/n (optional)
Network protocols	TCP/IP (IPv4 / IPv6); AppleTalk (EtherTalk); TCP; UDP
Printable paper size	A6-A4, customised paper sizes
Printable paper weight	60-163 gsm
Paper input capacity	Standard: 300 sheets Max.: 850 sheets
Paper tray 1	250 sheets, A6-A4, 60-90 gsm
Paper tray 2 (optional)	250 or 550 sheets, A5-A4, 60-120 gsm
Manual bypass	50 sheets, A6-A4, custom sizes, 60-163 gsm
Automatic duplexing	A4; 60-90 gsm
Output capacity	Max.: 150 sheets
Print volume (monthly)	Rec.: 3,600 pages
Toner lifetime	Up to 10,000 pages
Imaging unit lifetime	Up to 60,000 pages
Power consumption	220-240 V / 50/60 Hz Less than 520 W
System dimensions	399 x 382 x 263 mm
System weight	Approx. 14 kg

AccurioPrint C3070L



These first Konica Minolta production systems launched under the new Accurio brand name target small to mid-size commercial printers as well as in-house print rooms and Central Reprographic Departments (CRDs). As entry-level printing systems, they offer outstanding new features including scan & print to/from USB Flash, a dual colour high speed scanner and the possibility to manage print jobs directly from the operating panel. CRDs will find it easy to adapt to changing document workflows in the company, enhance their overall productivity and to extend their range of products and services by offering new, sophisticated print products.

Enhances overall productivity

TECHNICAL SPECIFICATIONS

SYSTEM SPECIFICATIONS

Resolution	1,200 x 1,200 dpi x 8 bit 1,200 x 3,600 dpi equivalent
Paper weight	62–350 gsm
Duplex unit	Non-stack type; 62–350 gsm
Paper sizes	330 x 487 mm; 330 x 1,300 mm (optional)
Maximum image area	323 x 480 mm; 323 x 1,295 mm (Banner)
Paper input capacity	Standard: 1,500 sheets Max.: 4,250 sheets
Paper output capacity	Max.: 3,100 sheets
Main unit dimensions (W x D x H)	800 x 903 x 1,076 mm
Main unit weight	319 kg

PRODUCTIVITY

AccurioPrint C2060L	
A4 - max. per minute	71 ppm
A3 - max. per minute	39 ppm
SRA3 - max. per minute	36 ppm
A4 - max. per hour	3,823 pph
A3 - max. per hour	2,113 pph
SRA3 - max. per hour	1,951 pph

CONTROLLER

Internal Konica Minolta Controller	IC-605 A
Internal Fiery Controller	IC-417

SCANNER SPECIFICATIONS

Scan speed A4	Up to 240 ipm
Scan modes	TWAIN scan; Scan-to-HDD; Scan-to-FTP; Scan-to-SMB; Scan-to-eMail
Scan formats	TIFF (single and multi page); PDF
Scan resolution	600 x 600 dpi

COPIER SPECIFICATIONS

Gradations	256 gradations
FCOT	Less than 8 sec. (colour A4)
Magnification	25–400%, in 0.1% steps
Multiple copies	1–9,999

ACCESSORIES

Original cover	OC-511
Automatic document feeder	DF-706
Working table	WT-511
Heating unit for main body trays	HT-511
Heating unit for LU-202m/XL	HT-503
Bypass tray	MB-506
Booklet finisher	FS-612
Staple finisher	FS-531
2/4-hole punch kit for FS-612/531	PK-512
2-hole punch kit for FS-612/531	PK-513
Post inserter for FS-612/531	PI-502
Envelope fuser	EF-103
Banner tray	MK-740
Banner tray for OT-510	MK-740m
Large capacity unit	LU-202m
Large capacity unit	LU-202XLm
High capacity output tray	OT-510
Output tray	OT-511
Envelope feeding kit	MK-746

- All specifications refer to A4-size paper of 80 gsm quality.
- The support and availability of the listed specifications and functionalities varies depending on operating systems, applications and network protocols as well as network and system configurations.
- The stated life expectancy of each consumable is based on specific operating conditions such as page coverage for a particular page size (5% coverage of A4).
- The actual life of each consumable will vary depending on use and other printing variables including page coverage, page size, media type, continuous or intermittent printing, ambient temperature and humidity.
- Some of the product illustrations contain optional accessories.
- Specifications and accessories are based on the information available at the time of printing and are subject to change without notice.
- Konica Minolta does not warrant that any prices or specifications mentioned will be error-free.
- All brand and product names may be registered trademarks or trademarks of their respective holders and are hereby acknowledged.



Konica Minolta AccurioPress C3080 Series
with EFI 417 Controller
Outstanding Light Production Colour Device

AccurioPress C3070/C3080



High-end print controller

Versatility and reliability are now combined with the AccurioPress C3070/C3080 digital colour print system, empowering print professionals to surpass their requirements for on-demand printing. With high print speeds of 81ppm on the AccurioPress C3070/C3080 and a massive 4,399 A4 sheets per hour or 2,113 SRA3 sheets per hour, the C3080 will manage those print deadlines with ease. The performance is equally matched by the extended capabilities of long sheet duplex, up to 762mm and professional envelope printing to name but a few, whilst colour consistency is controlled at a level to provide best results, time after time.

AccurioPress C3070

- Up to 71ppm A4, 39ppm A3
- Up to 36ppm SRA3
- Up to 3,820pph A4
- Up to 2,113pph SRA3

AccurioPress C3080

- Up to 81ppm A4, 45ppm A3
- Up to 39ppm SRA3
- Up to 4,399pph A4
- Up to 2,439pph SRA3

TECHNICAL SPECIFICATIONS

SYSTEM SPECIFICATIONS

Resolution	1,200 x 1,200 dpi x 8 bit 1,200 x 3,600 dpi equivalent
Paper weight	62–350 gsm
Duplex unit	Non-stack type; 62–350 gsm
Paper sizes	330 x 487 mm; 330 x 1,300 mm (optional)
Maximum image area	323 x 480 mm; 323 x 1,295 mm (Banner)
Paper input capacity	Standard: 1,500 sheets Max.: 15,390 sheets
Paper output capacity	Max.: 3,100 sheets
Main unit dimensions (W x D x H)	800 x 903 x 1,076 mm
Main unit weight	319 kg

CONTROLLER

Internal Konica Minolta Controller	IC-605 A
Internal Fiery Controller	IC-417
External Fiery Controller	IC-313
External Creo Controller	IC-314

SCANNER SPECIFICATIONS

Scan speed A4	Up to 240 ipm
Scan modes	TWAIN scan; Scan-to-HDD; Scan-to-FTP; Scan-to-SMB; Scan-to-eMail
Scan formats	TIFF (single and multi page); PDF
Scan resolution	600 x 600 dpi

COPIER SPECIFICATIONS

Gradations	256 gradations
FCOT	Less than 8 sec. (colour A4)
Magnification	25–400%, in 0.1% steps
Multiple copies	1–9,999

ACCESSORIES

Integrated Color Care Unit	IQ-501
Original cover	OC-511
Automatic document feeder	DF-706
Working table	WT-511
Heating unit for main body trays	HT-511
Air assist paper feed unit	PF-602m
Heating unit for PF-602m	HT-504
Air suction paper feed unit	PF-707m
Heating unit for PF-707m	HT-506
Heating unit for LU-202m/XL	HT-503
Bypass tray	MB-506
Relay unit	RU-518
Humidification unit	HM-102
Booklet making unit	SD-506
Booklet making unit	SD-513
Creasing unit for SD-513	CR-101
Slitting unit for SD-513	TU-503
Spine corner forming unit for SD-513	FD-504
Post inserter for FS-612/531	PI-502
Envelope fuser	EF-103
Banner tray	MK-740
Banner Tray for OT-510 and FS-532	MK-740m
Large capacity unit	LU-202m
Large capacity unit	LU-202XLm
Output tray	OT-510
High capacity output tray	OT-511
Envelope feeding kit	MK-746
Bypass tray for PF-707m	MB-508
Stapling unit	FS-532
Saddle stitch kit for FS-532	SD-510
Punch kit for FS-532	PK-522

- All specifications refer to A4-size paper of 80 gsm quality.
- The support and availability of the listed specifications and functionalities varies depending on operating systems, applications and network protocols as well as network and system configurations.
- The stated life expectancy of each consumable is based on specific operating conditions such as page coverage for a particular page size (5% coverage of A4).
- The actual life of each consumable will vary depending on use and other printing variables including page coverage, page size, media type, continuous or intermittent printing, ambient temperature and humidity.
- Some of the product illustrations contain optional accessories.
- Specifications and accessories are based on the information available at the time of printing and are subject to change without notice.
- Konica Minolta does not warrant that any prices or specifications mentioned will be error-free.
- All brand and product names may be registered trademarks or trademarks of their respective holders and are hereby acknowledged.

AccurioPress C6100/C6085



Print suppliers have many challenges, one being able to drive higher efficiencies in their digital print production environment. The AccurioPress C6100 and C6085 addresses these challenges with print technologies that deliver productivity while reducing both set-up and down time. Efficiency is achieved with rated print speeds of up to 100ppm, which equates to 5,455 printed sheets per hour, with three monthly duty cycles on the C6100 of 1.8 million.

The models offer productivity with rated print speeds across a large range of media types and weights - simplex and duplex printing is possible up to 400gsm, assuring that production time is kept to a minimum in order to meet client requirements.

AccurioPress C6100

- Up to 100ppm A4, 53ppm A3
- Up to 50ppm SRA3
- Up to 5,455pph A4
- Up to 2,902pph SRA3

AccurioPress C6085

- Up to 85ppm A4, 46ppm A3
- Up to 43ppm SRA3
- Up to 4,636pph A4
- Up to 2,520pph SRA3

TECHNICAL SPECIFICATIONS

SYSTEM SPECIFICATIONS

Resolution	1,200 x 1,200 dpi x 8 bit
	1,200 x 3,600 dpi equivalent
Paper weight	52–400 gsm
Duplex unit	Non-stack type; 52–400 gsm*
Paper sizes	330,2 x 487,7 mm
	330,2 x 762 mm with LU-202XLm
	330,2 x 1.300 mm with MB-508
Maximum image area	321 x 480 mm
	(for 330,2 x 487,7 mm papers)
Paper input capacity	Max.: 13,890 sheets
Paper output capacity	Max.: 13,600 sheets
Main unit dimensions (W x D x H)	950 x 950 x 1,319 mm
Main unit weight	440 kg

CONTROLLER

External EFI® Fiery Controller	IC-313
External EFI® Fiery Controller	IC-315
External CREO® Controller	IC-314
Internal Konica Minolta own Controller	IC-604

SCANNER SPECIFICATIONS**

Scan speed A4	Up to 160 ipm
Scan resolution	Max.: 600 x 600 dpi
Scan modes	TWAIN scan; Scan-to-HDD; Scan-to-FTP; Scan-to-SMB; Scan-to-eMail
Scan formats	TIFF (single and multi page); PDF

COPIER SPECIFICATIONS**

Gradations	256 gradations
Magnification	25–400%; in 0.1% steps
Multiple copies	1–9,999

ACCESSORIES

Integrated Color Care Unit	IQ-501
Envelope fusing unit	EF-104
Working table	WT-512
Air suction paper feed unit	PF-707m
Air suction paper feed unit with ADF	PF-711
Heating unit for PF-711/707m	HT-506
Large capacity tray	LU-202XLm
Multi bypass tray	MB-508
Conveyance unit	RU-518
Humidification unit	HM-103
Multi (GBC) punching unit	GP-501
Relay unit	RU-510
Auto ring binding unit	GP-502
Folding and punching unit	FD-503
Stacking unit	LS-506
Booklet making unit	SD-506
Booklet making unit	SD-513
Creasing unit for SD-513	CR-101
Slitting unit for SD-513	TU-503
Spine corner forming unit for SD-513	FD-504
3rd party interface	MK-737
Perfect binding unit	PB-503
Stapling unit	FS-532
Saddle stitch kit for FS-532	SD-510
Punch kit for FS-532	PK-522
Post inserter for FS-532	PI-502
Watkiss PowerSquare™	224KR
Plockmatic	SD-500/SD-350
Open Stacker	OT-510

* Only recommended paper ** Requires PF-711

AccurioLabel 190



AccurioLabel 190 has been created to take centre stage on the globally-expanding digital label market. Adoption of a production printer as the engine, which represents the culmination of cutting-edge technologies amassed by Konica Minolta over a span of many years. AccurioLabel 190 contributes to business expansion by perfectly balancing customer needs from the perspectives of quality and cost.

- High image quality of 1,200 dpi,
- Maximum speed of 18.9m
- Ensures facilitation of work during procedures such as maintenance and job changes

AccurioLabel 190 digital label printer offers outstanding productivity, image quality, operability and economy, is a 'perfect fit' for new market expansion and parallel use with existing analogue machines. Label converters and commercial printers face an increasing number of print jobs for small to medium editions, which they are expected to produce in ever-shorter processing times. With conventional flexo and offset printing, it is hardly possible to produce such orders profitably. However, they can be processed easily and efficiently thanks to the flexibility of digital printing.

TECHNICAL SPECIFICATIONS

SYSTEM SPECIFICATIONS

Technology	Dry Toner Electrophotography
Resolution	1,200 x 1,200 dpi x 8 bit 1,200 x 3,600 dpi equivalent
Paper width	330 mm
Max. printed image size	1195 x 320 mm
Max. printed image width	320 mm
Grammage / substrate thickness	60 to 250 µm
Possible substrates	Paper, YUPO, PP, PET
Feeding speed (printing speed)	18.9 m/min., 13.5 m/min., 9.45 m/min. Speed depends on the paper type (standard speed: 13.5 mm)
Unit dimensions (W x D x H)	3,869 x 1,138 x 1,480 mm
Unit weight	947 kg
Web control	Integrated web guide system (BST) on unwinder and rewinder
Converting	Capability to connect selected finishing device

CONTROLLER

Internal Konica Minolta Controller IC-602

- The support and availability of the listed specifications and functionalities varies depending on operating systems, applications and network protocols as well as network and system configurations.
- The actual life of each consumable will vary depending on use and other printing variables including coverage, size, media type, ambient temperature and humidity.
- Specifications are based on the information available at the time of printing and are subject to change without notice.
- Konica Minolta does not warrant that any specifications mentioned will be error-free.
- All brand and product names may be registered trademarks or trademarks of their respective holders and are hereby acknowledged.



Konica Minolta AccurioPress 6136 Series
with Internal Image Controller
Outstanding Light/Mid-Volume Production Device

AccurioPress 6120/6136



In the fast-growing, digital high-volume print market, in-house printers and graphic communication providers have to focus on building up their business by producing a wider range of high-volume jobs more efficiently. For that, they need the best performance available in the market - the AccurioPress 6136 series comprises three models, the fastest of which provides a maximum speed of 7,940 A4 pages per hour. Latest technologies guarantee maximum uptime and outstanding black & white print quality. The superior product outline impresses with a comprehensive range of inline finishing options.

AccurioPress 6120

- Black & white
- 120ppm A4
- SRA3 66ppm

AccurioPress 6136

- Black & white
- 136ppm A4
- SRA3 74ppm

TECHNICAL SPECIFICATIONS

SYSTEM SPECIFICATIONS

Resolution	1,200 x 1,200 dpi
Paper weight	40–350 gsm
Duplex unit	Non-stack type; 40–300 gsm
Paper sizes	Min.: 95 x 139 mm Max.: 324 x 483 mm (with PF-710)
Maximum image area	314 x 483 mm (with PF-710)
Paper input capacity	Standard: 3,000 sheets Max.: 18,000 sheets
Paper output capacity	Max.: 15,000 sheets (plus sub trays)
Main unit dimensions (W x D x H)	990 x 910 x 1,454 mm
Main unit weight	396 kg

PRODUCTIVITY

AccurioPress 6136/P	
A4 - max. per minute	136 ppm
A3 - max. per minute	78 ppm
SRA3 - max. per minute	74 ppm
A4 - max. per hour	7,940 pph
A3 - max. per hour	4,526 pph
SRA3 - max. per hour	4,274 pph
AccurioPress 6120	
A4 - max. per minute	120 ppm
A3 - max. per minute	70 ppm
SRA3 - max. per minute	66 ppm
A4 - max. per hour	7,034 pph
A3 - max. per hour	4,072 pph
SRA3 - max. per hour	3,846 pph

CONTROLLER

Embedded Konica Minolta Controller

SCANNER SPECIFICATIONS

Scan speed A4	Up to 240 ppm
Scan resolution	600 x 600 dpi
Scan modes	TWAIN scan; Scan-to-HDD; Scan-to-FTP; Scan-to-SMB; Scan-to-eMail
Scan formats	PDF; TIFF; secured PDF; XPS

COPIER SPECIFICATIONS

Gradations	256 gradations
FCOT	Less than 2.6 sec. (A4 LEF)
Magnification	25–400%, in 0.1% steps
Multiple copies	1–9,999

ACCESSORIES

Integrated Color Care unit	IQ-501
Air assist paper feed unit	PF-709
Pre-printed paper feed kit for PF-706	PP-701
Air suction paper feed unit	PF-710
Heating unit for PF-710	HT-506
Post Insertion unit	PI-PFU
Relay unit	RU-518
Humidification unit	HM-103
Multi (GBC) punching unit	GP-501
Relay unit	RU-510
Auto ring binding unit	GP-502
Folding and punching unit	FD-503
Stacking unit	LS-506
Booklet making unit	SD-506
Booklet making unit	SD-513
Creasing unit for SD-513	CR-101
Slitting unit for SD-513	TU-503
Spine corner forming unit for SD-513	FD-504
Perfect binding unit	PB-503
Stapling unit	FS-532
Saddle stitch kit for FS-532	SD-510
Punch kit for FS-532	PK-522
Post inserter for FS-532	PI-502
Open Stacker	OT-510
Envelope fuser	EF-105
Mount kit for 3rd party	MK-737
Removable HDD Kit	RH-101 & HD-511
Watkiss PowerSquare™ 224KR	
Plockmatic	SD-500/SD-350
GBC Punch G2	

bizhub PRO 1100



Unmatched reliability

The bizhub PRO 1100 is an affordable but powerful production system dedicated to central in-house printing facilities and external print-for-pay services. This device offers a sturdy construction, high performance and numerous in-line finishing options, that team up with technologies for enhanced black & white print quality. Experience remarkable productivity with high speed, dual scanning ADF, in combination with the powerful print engine.

- Black & white
- SRA3
- 100ppm A4

TECHNICAL SPECIFICATIONS

SYSTEM SPECIFICATIONS

Resolution	1,200 x 1,200 dpi
Paper weight	40–300 gsm (350 gsm optional*)
Duplex unit	Non-stack type; 40–300 gsm
Paper sizes	Standard: Min.: 182 x 139 mm Max.: 324 x 463 mm Optional: Min.: 95 x 139 mm* Max.: 324 x 483 mm**
Maximum image area	314 x 463 mm (up to 483 mm** optional)
Paper input capacity	Standard: 3,000 sheets Max.: 9,000 sheets
Paper output capacity	Max.: 4,200 sheets
Main unit dimensions (W x D x H)	990 x 910 x 1,454 mm
Main unit weight	340 kg

PRODUCTIVITY

A4 - max. per minute	100 ppm
A3 - max. per minute	56 ppm
SRA3 - max. per minute	53 ppm
A4 - max. per hour	6,000 pph
A3 - max. per hour	3,300 pph
SRA3 - max. per hour	3,120 pph

CONTROLLER

Embedded Konica Minolta controller
External Creo Controller IC-309m

* Requires PF-709

** Requires LU-412

SCANNER SPECIFICATIONS

Scan speed A4	Up to 180 opm
Scan resolution	600 x 600 dpi
Scan modes	Scan to HDD; Scan to FTP; Scan to PC; Scan to eMail; Scan to WebDAV; Scan to USB Memory; HDD to FTP/SMB/WebDAV
Scan formats	TIFF; PDF; Encrypted PDF; Compact PDF; XPS; JPEG

COPIER SPECIFICATIONS

Gradations	256 gradations
FCOT	Less than 3.4 sec. (A4 LEF)
Magnification	25–400%, in 0.1% steps
Multiple copies	1–9,999

ACCESSORIES

Large capacity tray A4	LU-411
Large capacity tray SRA3	LU-412
Air assist paper feed unit	PF-709
Multi (GBC) punching unit	GP-501
Auto ring binding unit	GP-502
Stapling unit	FS-532
Saddle stitch kit for FS-532	SD-510
Punch kit for FS-532	PK-522
Post inserter for FS-532	PI-502
Removable HDD Kit	RH-101 & HD-523
Multi bypass tray	MB-507 **
Output tray	OT-507

PaperCut



CHARACTERISTICS

PaperCut MF is regarded as the simplest system of its type to deploy and manage. System administrators have full access to administration and configuration via a familiar web interface.

KEY FEATURES

ARCHITECTURE

- Single server or multi-server
- Monitor locally attached printers
- Client software is optional
- 32-bit and 64-bit native

SUPPORTED SERVER OPERATING SYSTEMS

- Microsoft Windows Server (any edition including 64-bit and server core)
- Mac OS X Server (10.4 or higher)
- Linux (any modern distribution)
- Novell OES Linux and iPrint

USER DIRECTORY

- Active Directory (native integration including nested groups and OU's)
- Open Directory
- eDirectory
- LDAP
- NIS, PAM, Samba and others

ENCRYPTION

- SSL encryption used for sensitive client server communication

SUPPORTED FAILOVER

- Microsoft Failover Server
- Microsoft Cluster Server
- Veritas Cluster Server
- Linux HA and Novell Cluster

SUPPORTED WORKSTATION OPERATING SYSTEMS

- Microsoft Windows (any edition)
- Mac OS X (10.4 or higher)
- Linux (any modern distribution)
- Unix Workstation (Java required to run client software)

DATABASE SERVERS

- Self managing internal database - suitable for up to 5,000 end users
- Microsoft SQL Server 2000/2005/2008/2012/2014 (either 32 or 64 bit)
- Microsoft SQL Express 2005/2008/2012/2014 (free from Microsoft)
- PostgreSQL 7.1 or higher
- MySQL 5.0 or higher
- Oracle 9.2 or higher

PageScope Net Care Device Manager

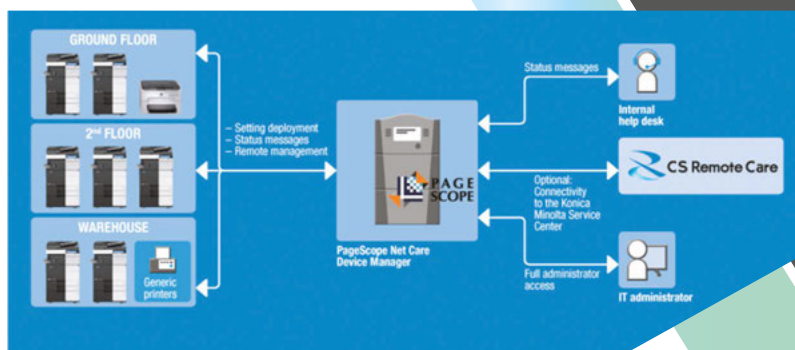

CHARACTERISTICS

Reduces administrator time and effort by managing networked output devices centrally and remotely.

You need accurate status reports and snapshots of usage, which you get with detailed monitoring based on M2M communication.

Covering a central device database and monitoring functionality, the Net Care Device Manager streamlines the complete management of all output devices in the corporate network and provides a welcome feature set to any company's IT administrator.

The Net Care Device Manager is the core element of the PageScope Enterprise Suite, which enhances and extends the capabilities with advanced output management, follow-me printing, user management, cost reporting and scan management.

MONITORING

- Considerably improves the quality and efficiency of internal IT services

AUTOMATED SERVICES

- Ensures that all staff can concentrate fully on their real tasks and competencies

REPORTING

- Avoids time-intensive investigations to obtain data for status overviews and usage analysis

CENTRALISATION

- Saves time and money, letting IT staff organise their core tasks more efficiently

DEVICE SETTINGS

- Provides convenient remote handling of device set-up and adjustments

YSoft SafeQ

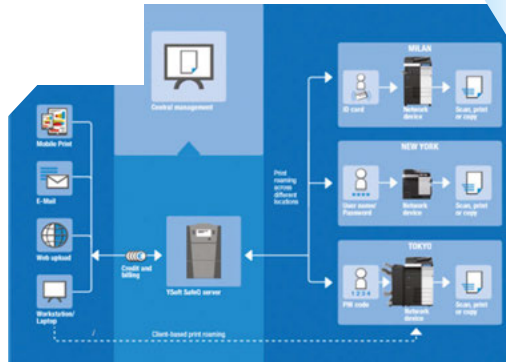

CHARACTERISTICS

Centralised user management
Print accounting and monitoring
Easy budget assignment
Management reports

Output
Management



KEY FEATURES

CENTRAL USER AND ROLE MANAGEMENT

- Centralised user management
- Permission templates
- Centralised authentication management

COST ASSIGNMENT AND CHARGEBACK

- Print accounting and monitoring
- Automatic tracking
- Tracking of third-party devices
- Individual price calculation
- Flexible cost allocation
- Monitoring of local printers

BUDGET AND QUOTA MANAGEMENT

- Easy budget assignment
- Periodic budget reset
- YSoft payment system
 - Cash desk reload
 - Self-service reload
 - Credit card reload

DETAILED OUTPUT AND COST REPORTING

- Web reports
- Management reports
- Export of report results
- Automated reporting

Document Navigator



CHARACTERISTICS

Document capture
Document processing
Document distribution
Content management

Document
Capture and
Management



KEY FEATURES

DOCUMENT CAPTURE

Various sources
MFP-embedded
Secure capturing
Limitation of scanning options

CONTENT MANAGEMENT

Reliable OCR text recognition
Popular file formats
Barcode recognition
Image improvement
Freeform and one recognition

dokoni FIND



CHARACTERISTICS

Document capture
Document processing
Document distribution
Content management

Document
Capture and
Management



KEY FEATURES

DOCUMENT CAPTURE

- Content virtualisation
- Universal data access
- Data connectivity
- Content conversion

CONTENT MANAGEMENT

- Enterprise search
- Data remains in place
- Central portal with SharePoint usage
- Integrated security
- Simple scale-up options
- Mobile application for Android & IOS
- Recently accessed, most assessed and favourites

KM Professional

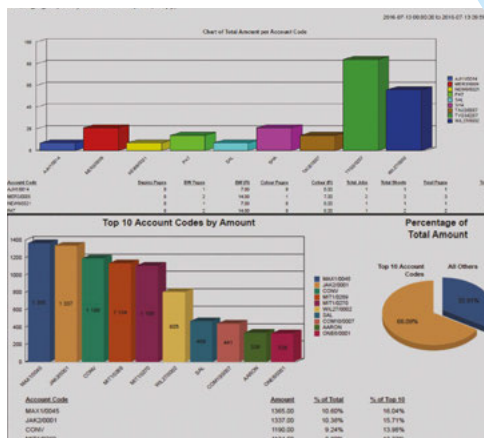

CHARACTERISTICS

No extra hardware
Variable pricing between users/
clients/matters/projects
'Follow Me' printing
Simple administration
Extensive graphical reporting
Rule based printing and alerts

Output
Management



KEY FEATURES

- Automated client billing
- Currently supporting AJS, LegalSuite, Legal Interact Practice Manager, GhostPractice, Lawplan, Winlaw and Lexpro
- Integration into other systems available on request

BENEFITS

- Allows for billing prints/copies/scans/faxes/phone calls to clients/matters/projects
- Improve recoveries with automated disbursement billing
- Free up admin staff time from manual disbursement capture
- Reduce waste
- Discover optimal deployment of office equipment
- Better supplies management
- Control access to office equipment
- Centralise management of printing infrastructure

LK-114

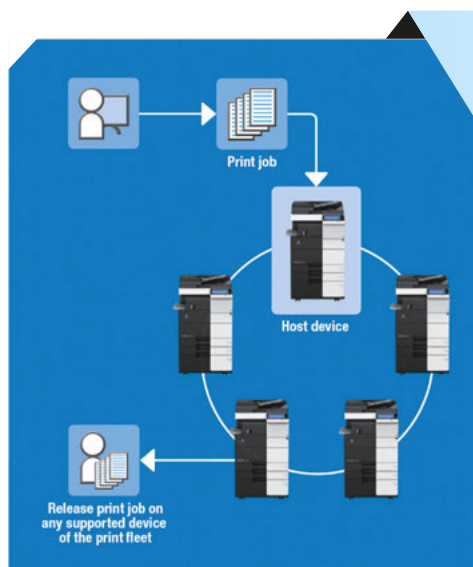

CHARACTERISTICS
 Serverless Pull Printing function
 Authenticated security
 LK-114 relieves IT administration

Serverless
printing



KEY FEATURES

- Print jobs can be received/printed at any device belonging to the Pull Printing group
- Print job release requires authentication by the user
- LK-114 is provided as an i-Option and required for all devices belonging to the Pull Printing group

BENEFITS

- LK-114 boasts a server-less Pull Printing environment, allowing you to print jobs from a PC and temporarily stored on a storage device to any bizhub MFP or printer within the same group (ubiquitous group)
- It enhances convenience and at the same time, contributes to security and reduction of overall costs

EveryonePrint

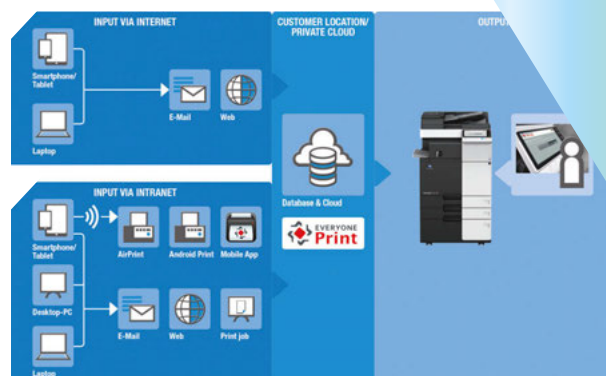

CHARACTERISTICS
 Secure printing
 Flexible job submission
 Support of BYOD corporate policy
 Accounting & charging
 Support of file formats & output settings

Cloud and
Mobile Printing



KEY FEATURES

- Administrator-controlled user access
- End-to-end file encryption
- Private print cloud environment
- Follow-me printing
- Guest print scenario
- Secure print job release
- Authentication via PIN
- Authentication by ID card (optional)
- Authentication via user name and password

FLEXIBLE JOB SUBMISSION

- Driver print
- E-mail print
- Web print
- Mobile print
- Google Cloud print

bizhub SECURE



CHARACTERISTICS

Lock down protection
Enhanced password and data security measures
Professional safeguard services

Security



KEY FEATURES

THE FOLLOWING SECURITY FEATURES WILL BE ENABLED ON YOUR MFP BASED ON YOUR MODEL TYPE

- Change administrator password
- Enable hard drive encryption
- Timed automatic overwrite of a file in an electronic folder (Box)
- Automatic Overwrite of temporary image data

- Hard Drive Lock Password
- Timed, automatic Deletion of a file in an electronic folder*
- Deletion does not overwrite the data on the hard drive

bEST GUARD

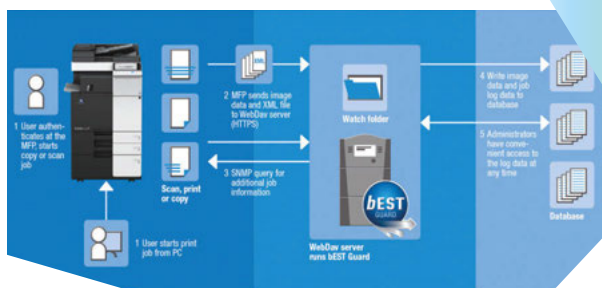

CHARACTERISTICS

Free security
Device access control
Data leakage prevention
Document security

Security



KEY FEATURES

DATA LEAKAGE PREVENTION

- Automatic image logging
- Powerful database browser
- Log report and e-mail alerts
- Simple set-up
- MFP monitoring and recording

PLEASE NOTE

- The implementation of bEST Guard is only useful in combination with an authentication application
- The application is bound to data protection requirements which can vary in accordance with national regulations

asset360

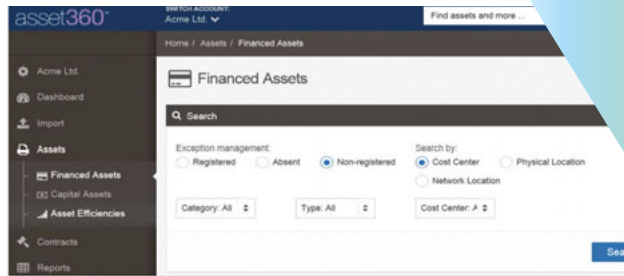

CHARACTERISTICS

- Enables a financial facilities and cost accounting view on enterprise assets
- Provides a fixed rental and loan asset registry
- Offers control and governance to capital and non-capital assets



KEY FEATURES

- Enterprise asset management
- Financial management
- Operational cost management
- Cost accounting
- Asset efficiency
- Establishment of geographical entities
- Overall equipment effectiveness

OnBase by Hyland

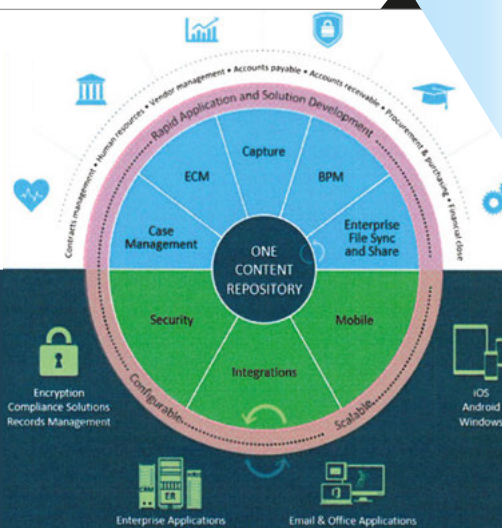

OnBase is a single enterprise information platform for managing content, processes and cases. OnBase has transformed thousands of organisations worldwide by empowering them to become more agile, efficient and effective.

Single Enterprise Information Platform



ONBASE SOLUTION AREAS

HEALTHCARE

Health Information, Management, Clinical, Patient Access, Patient Financial, Services and Health Insurance

GOVERNMENT

Justice & Public Safety, Health & Human Services, Planning & Public Works, Finance & Administration

FINANCIAL SERVICES

Banking, Wealth Management, Credit Unions and ending

INSURANCE

Property & Casualty, Life, Health & Annuity, Third Party and Administrators

HIGHER EDUCATION

Enrolment, Management, Advancement & Athletics, Senior Administration and Business Office

ADDITIONAL INDUSTRIES

Manufacturing, Retail, Transportation, Global Trade, Construction, Food & Beverage, Mining, Oil & Gas, Utilities and more